

1-L

STATE OF DELAWARE
DEPARTMENT OF NATURAL RESOURCES
AND ENVIRONMENTAL CONTROL
1-31-4.00-7.00
D.R. 2458 01

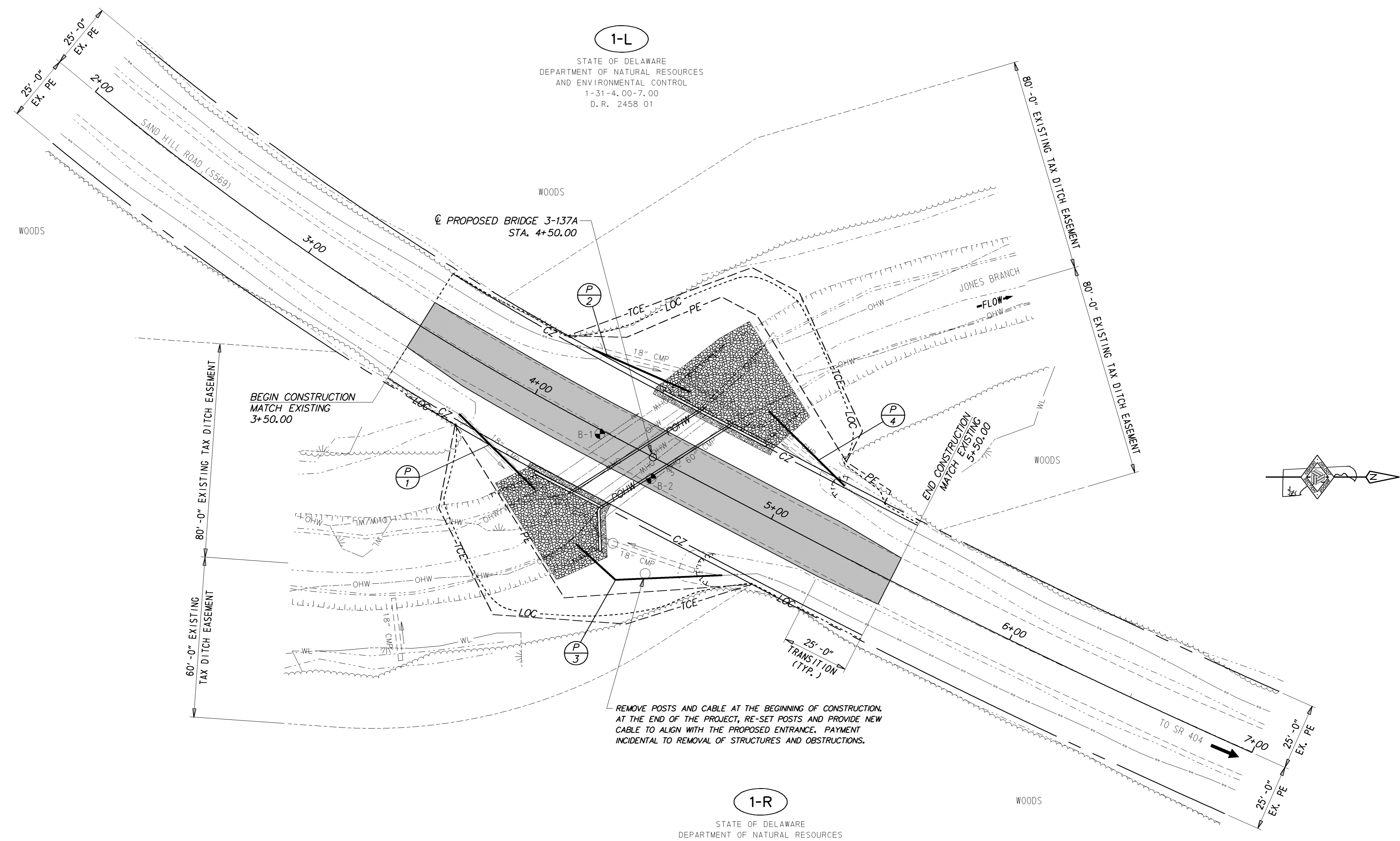

REMOVE POSTS AND CABLE AT THE BEGINNING OF CONSTRUCTION. AT THE END OF THE PROJECT, RE-SET POSTS AND PROVIDE NEW CABLE TO ALIGN WITH THE PROPOSED ENTRANCE. PAYMENT INCIDENTAL TO REMOVAL OF STRUCTURES AND OBSTRUCTIONS.

1-R

STATE OF DELAWARE
DEPARTMENT OF NATURAL RESOURCES
AND ENVIRONMENTAL CONTROL
1-31-4.00-12.00
D.R. 2458 01

DRAINAGE PIPE SCHEDULE

NO.	SIZE / TYPE	CLASS	LENGTH	SLOPE	INT. EL.	DIS. EL.
1	18" HDPE	S	40.00'	3.00%	30.00	28.80
2	18" HDPE	S	40.00'	3.00%	29.75	28.55
3	18" HDPE	S	60.00'	3.00%	29.75	27.95
4	18" HDPE	S	40.00'	3.00%	30.00	28.80

PIPE #3 SHALL INCLUDE A 45° BEND COUPLER INCIDENTAL TO THE PIPE RUN.

ADDENDUMS / REVISIONS

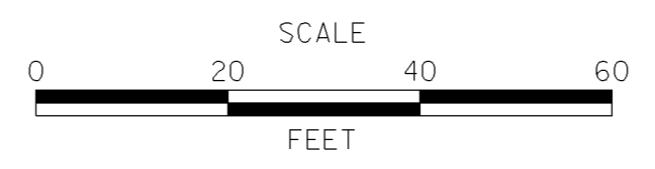

**BR 3-137A ON
S569 SAND HILL ROAD
OVER JONES BRANCH**

CONTRACT	BRIDGE NO.	3-137A
T201507303	DESIGNED BY:	GCL III
COUNTY	CHECKED BY:	CAS
SUSSEX		

CONSTRUCTION PLAN

SHEET NO.	5
TOTAL SHTS.	14

W:\MSV8\CELLS\PROVIDE\SB.CEL

